

Notice for Switch Parts of Movable Core Support

We highly appreciate for your continuous sales support on Mitsubishi Hoist and related items. This time, we would like to make an announcement of switch parts in movable core support accordingly.

1. Changed contents

For quality improvement purpose, shape of movable core support will be partially changed accordingly.

2. Reason for changes

Countermeasures against removal of snap pin when closing the electromagnet box lid.

⇒ Related materials : 855-0306 Notice for when closing the lid for AC brake electromagnet box

3. Subject models

Current product ...S type:7.5t or more, U2(HU2)type:7.5tor more, US(HUS)type:7.5t or more

Discontinued product ... HY type, HY-A type: 5tor more, S type: 5t-2 type

※Other type of models using magnet assembly and composite service parts.

4. Schedule for changes

Product : Change will be made production from October 2021.

Service parts: Switch will be made after running out of stock of current parts.

(※There is no change in parts code)

5. Changed contents

▪ Dimensions : There is no change in the main dimensions.

▪ Compatibility : Compatible in assembly. No change in assembly method.

There is no problem of using current and switching parts. (10t or more)

▪ Appearance : Kindly check the photo below.

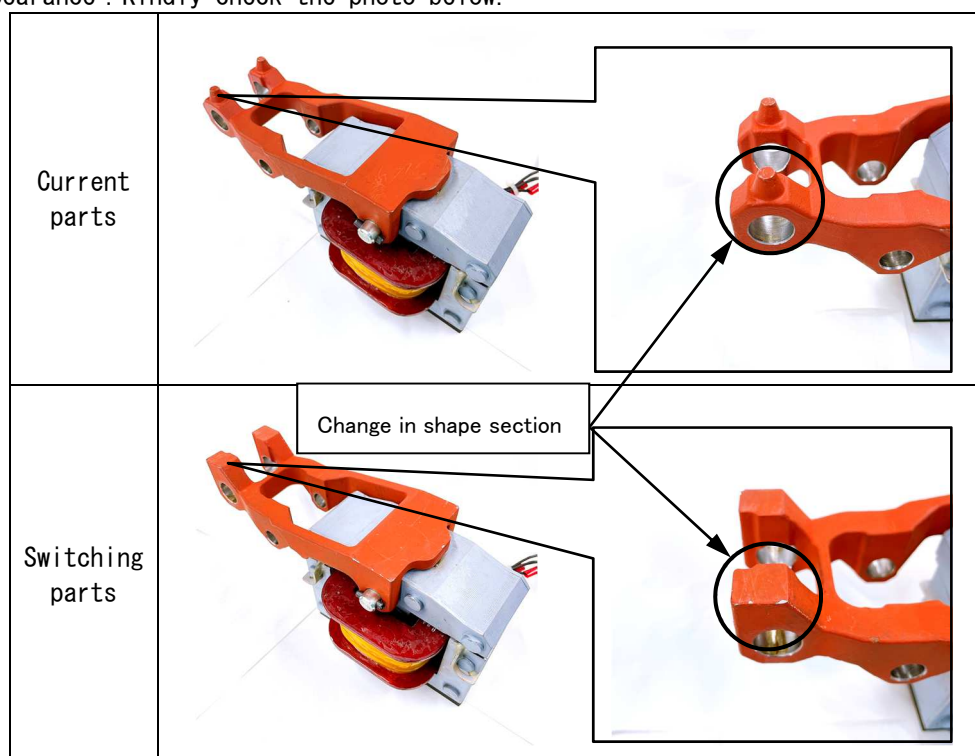

Subject	Notice for Switch Parts of Movable Core Support	Date of issue	September 22, 2021
		MITSUBISHI ELECTRIC FA INDUSTRIAL PRODUCTS CORPORATION 1-1-1 Imajuku-Higashi, Nishi-ku, Fukuoka 819-0192 TEL 092-805-3631	